

The project is both an artistic interpretation of the astronomic Solar System and an ideal symbol of the United Arab Emirates: the position of the planets corresponds to the configuration of the Solar System on December 2nd 1971, the day in which the United Arab Emirates were founded.

THE ASTRONOMIC SOLAR SYSTEM
ON DECEMBER 2nd 1971

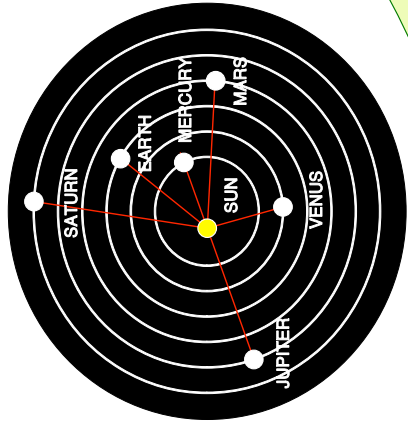

THE PHOTOVOLTAIC
SOLAR SYSTEM

- 1 - Sun
- 2 - Craters
- 3 - Atmosphere
- 4 - Earth
- 5 - Crescent
- 6 - Ring
- 7 - Eclipse
- 8 - Gas giant

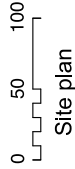
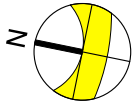

Site plan



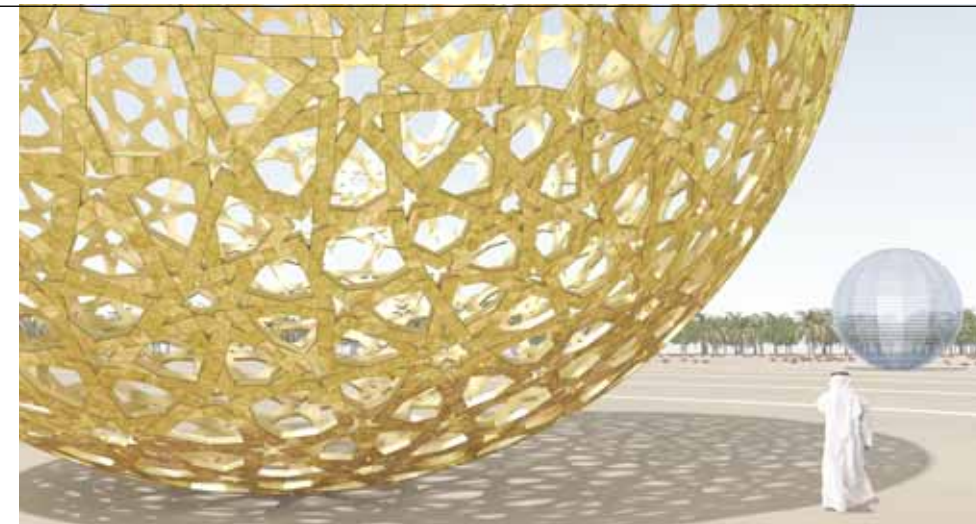

The artwork creates a new sun generating light and electric power for the future urban area of Masdar.

The geometrical pattern of the photovoltaic sun is composed by golden thin film solar cells with multicrystalline silicon (mc-Si).

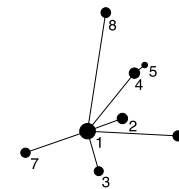

Elevation of photovoltaic sun (1)

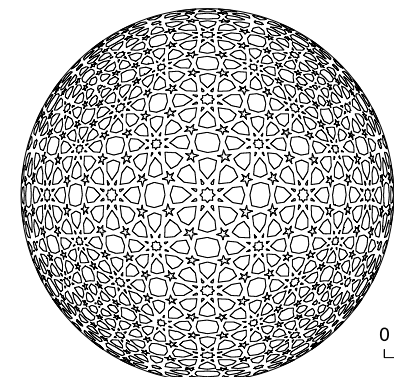

4 - The Earth

5 - The Crescent



3 - The Atmosphere

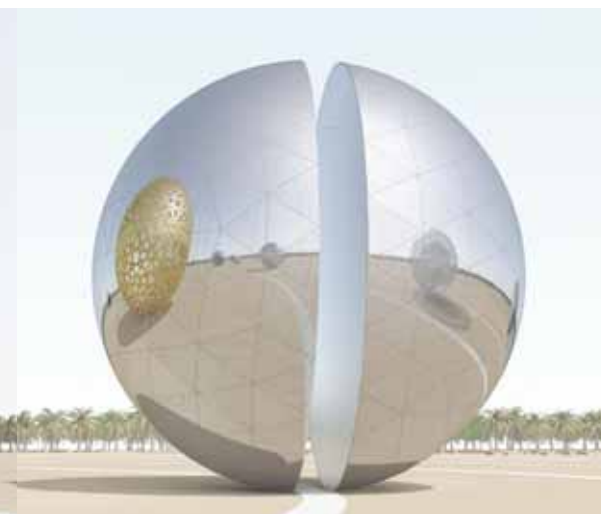

6 - The Ring



Life on earth is symbolized by an already existing tree, which lives within a photovoltaic greenhouse. The Moon on the surface has an opening with the shape of a crescent.

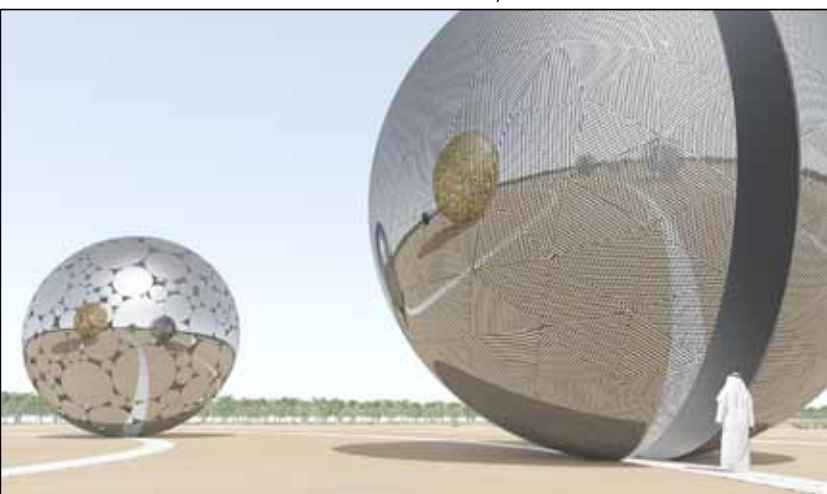
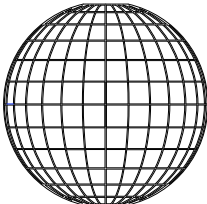
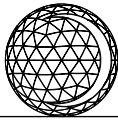

0 5
Elevations

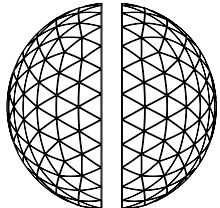

The earth and the crescent (CIGS panels with the serigraphy of the continents)

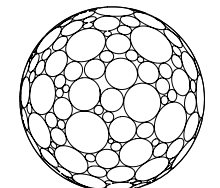
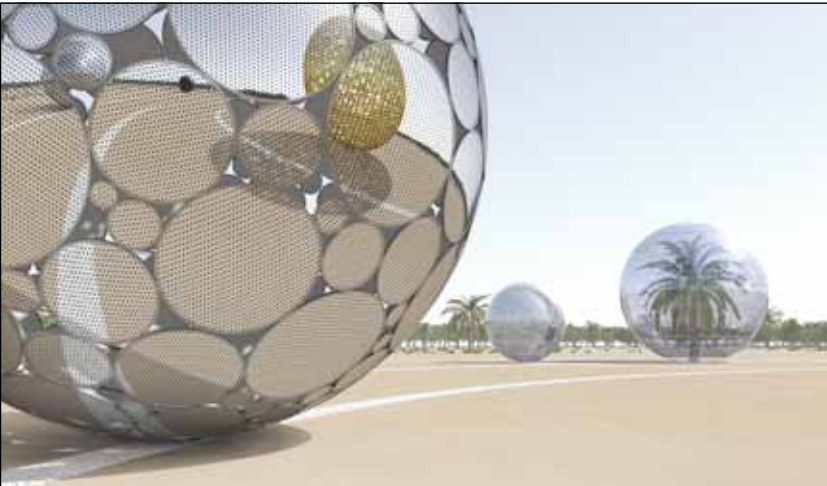
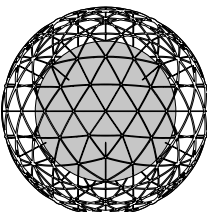
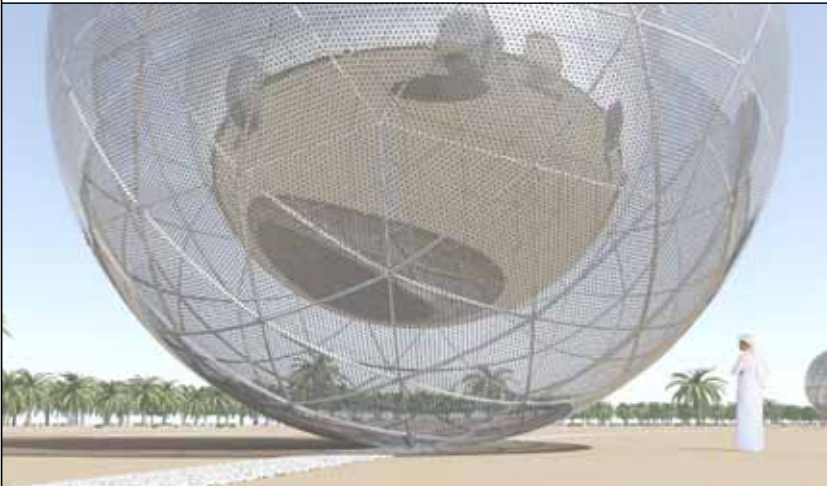

The ring (mc-Si solar cells)

The atmosphere (CIGS panels)



STRATEGIES

- Photovoltaic planets: multiplicity, differentiation, interactions
- Possibility to organize the internal space of planets with educational and entertaining facilities, such as a scientific exhibition regarding the new photovoltaic technologies
- Flexible system: the dimensions and numbers of planets are indicative, depending on construction cost or amount of energy produced

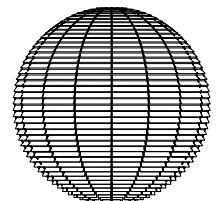
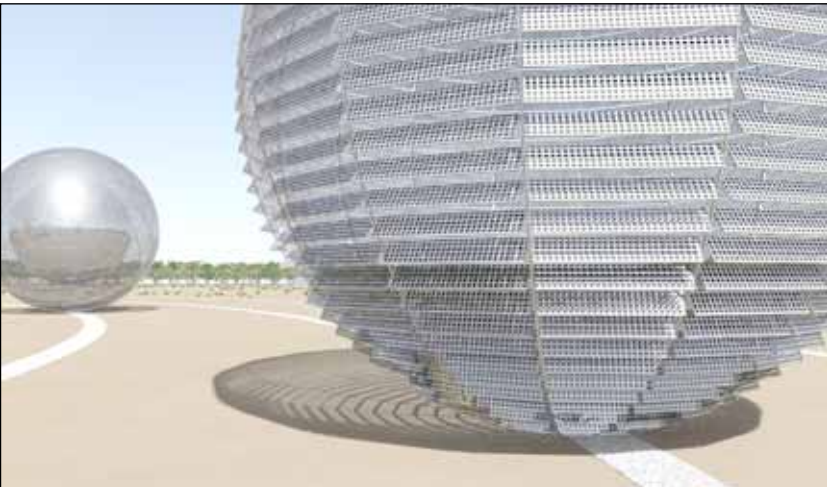

The craters (mc-Si solar cells)

The eclipse (CIGS panels)

The Gas Giant (CIGS panels on a photovoltaic solar shading system)



STRATEGIES:

- Continuity of nature
- Environmental sustainability: soft intervention due to limited contact zones on natural ground
- Open system without separations for the public
- Land(mark) Art: stony orbits visible from the landing planes of the nearby airport

Aerial view

