

# EDDY LINE

PROJECT PARTNERS

Land Art Generator Initiative  
Willimantic Whitewater Partnership  
Institute for Sustainable Energy at ECSU  
Connecticut DECD Office of the Arts

DESIGN TEAM

Gray Organschi Architecture  
Höweler + Yoon Architecture  
Push Studio  
Nspire Green

“An eddy line is the seam between a river’s faster, main jet of current and the slower current of an eddy. Crossing a placid eddy line gives pause on quiet waters—time, perhaps, to leave the mainstream and admire a pale ellipse of sand draped along the bank.”  
-Ellen Meloy, *Home Ground*

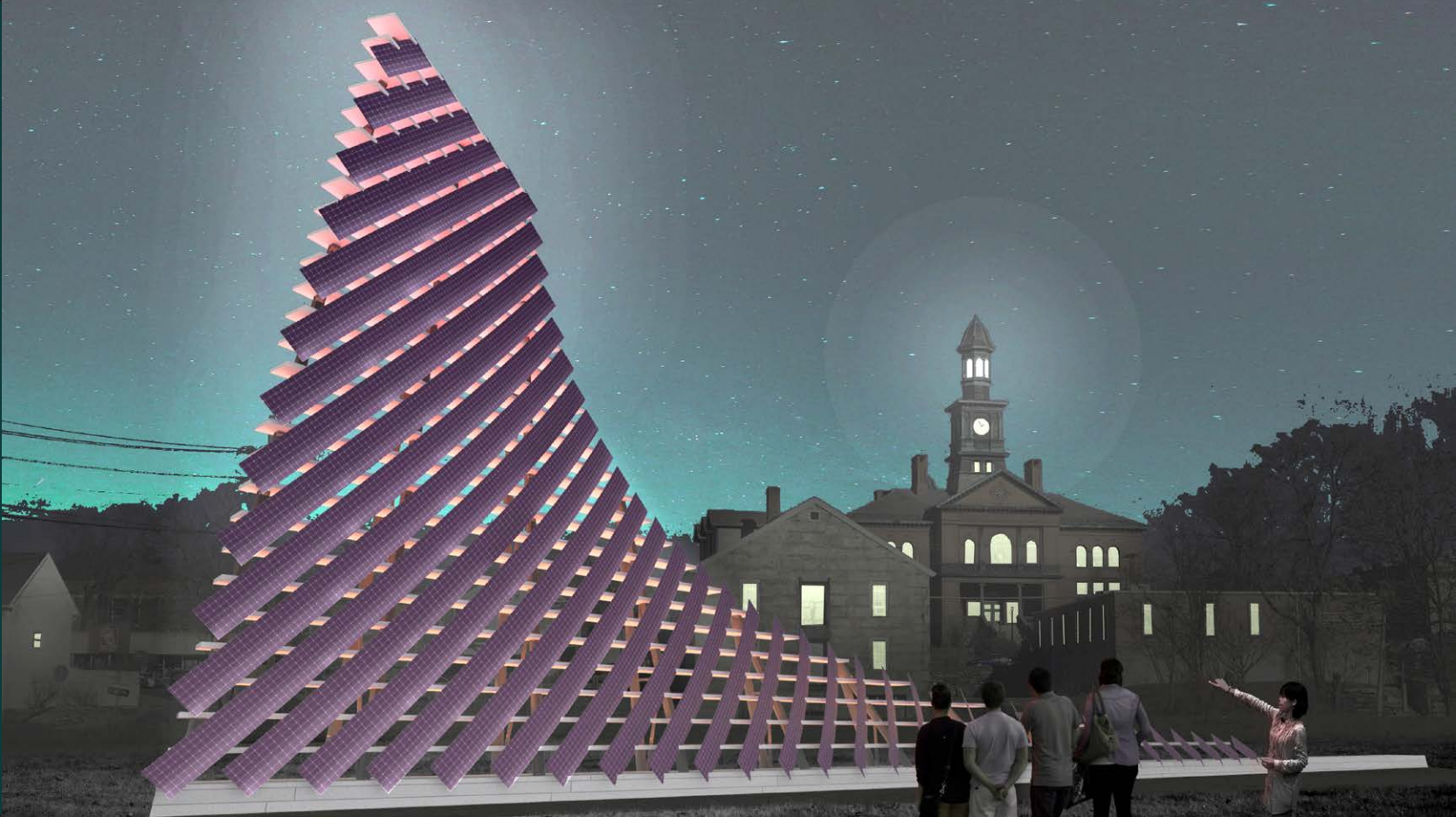



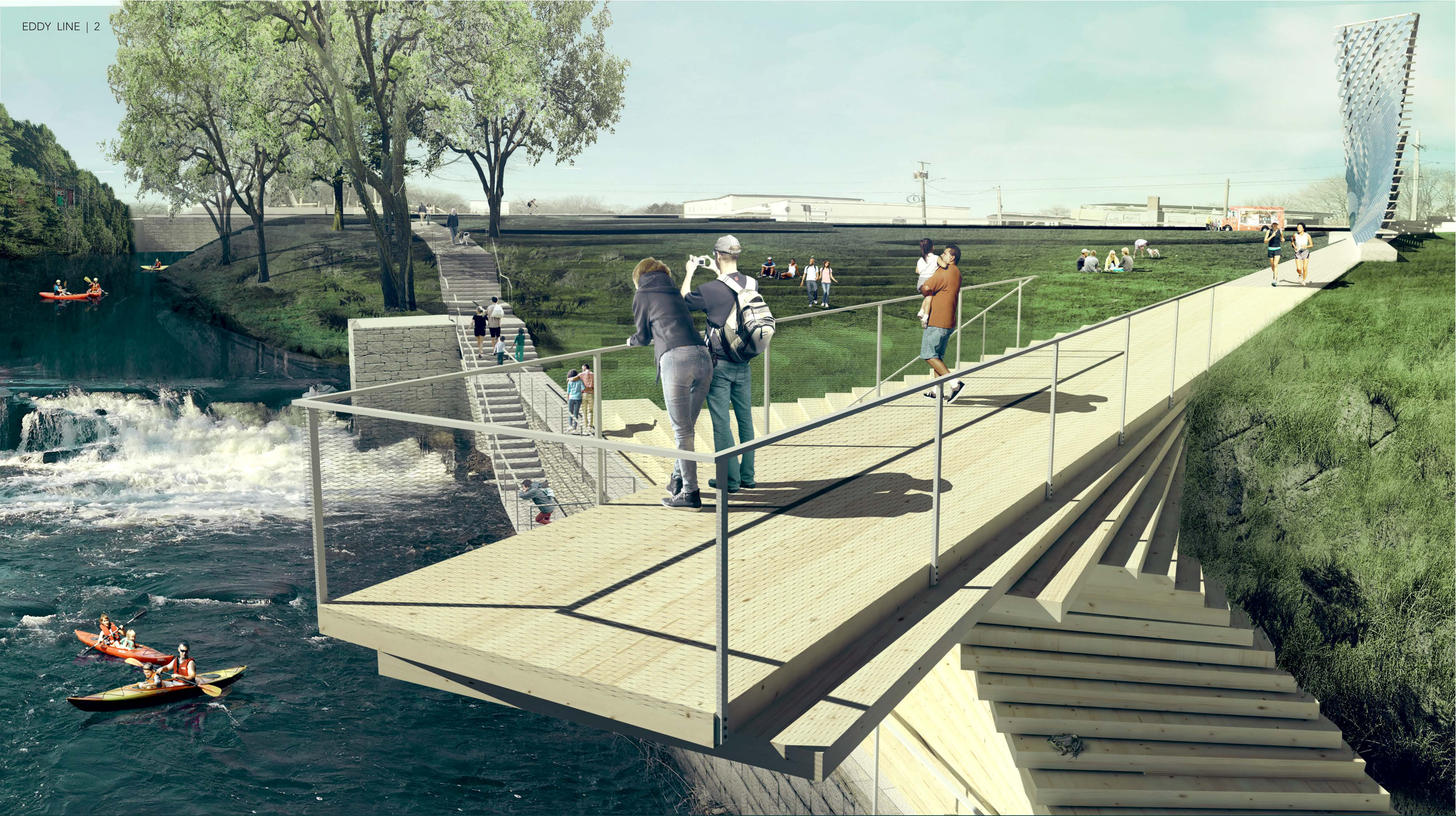

I. SOLAR BEACON

A striking beacon marks the corner of Bridge Street and Riverside Drive, welcoming pedestrians into the park beyond. Conceived as an “energy billboard,” the beacon’s south-facing PV array gathers solar energy by day and emits a gentle glow to the north by night.

As light bounces across the structure’s fanning horizontal fins, changes in color broadcast a signal to the community. Different colors might signal data about river flow, local energy consumption, holidays, or weather events.

II. AMPHITHEATER

Fanning planks of cross-laminated timber generate a river-facing amphitheater nestled into a natural depression on the site. At the crest of the amphitheater, an overlook springs out over the existing stone retaining wall, providing dramatic views of the river’s historic dam and future whitewater features.

The south-facing bowl of the amphitheater will provide a sunny spot for hikers, cyclists, and residents to enjoy a reprieve in nature. During festivals, competitions, or other cultural events, the stepped seating provides plenty of room for community fun.

III. KAYAK CHUTE/PICNIC AREA

A visual complement to the amphitheater, the kayak chute twists and banks into the slope, forming bench seating, a picnic table and ultimately, a path into the water. Entering the river just upstream of the historic dam, boaters may traverse the falls and then take out at a landing just below the dam for a quick portage back to the chute. This self-contained loop provides an ideal environment for whitewater demonstrations, training, or competition.



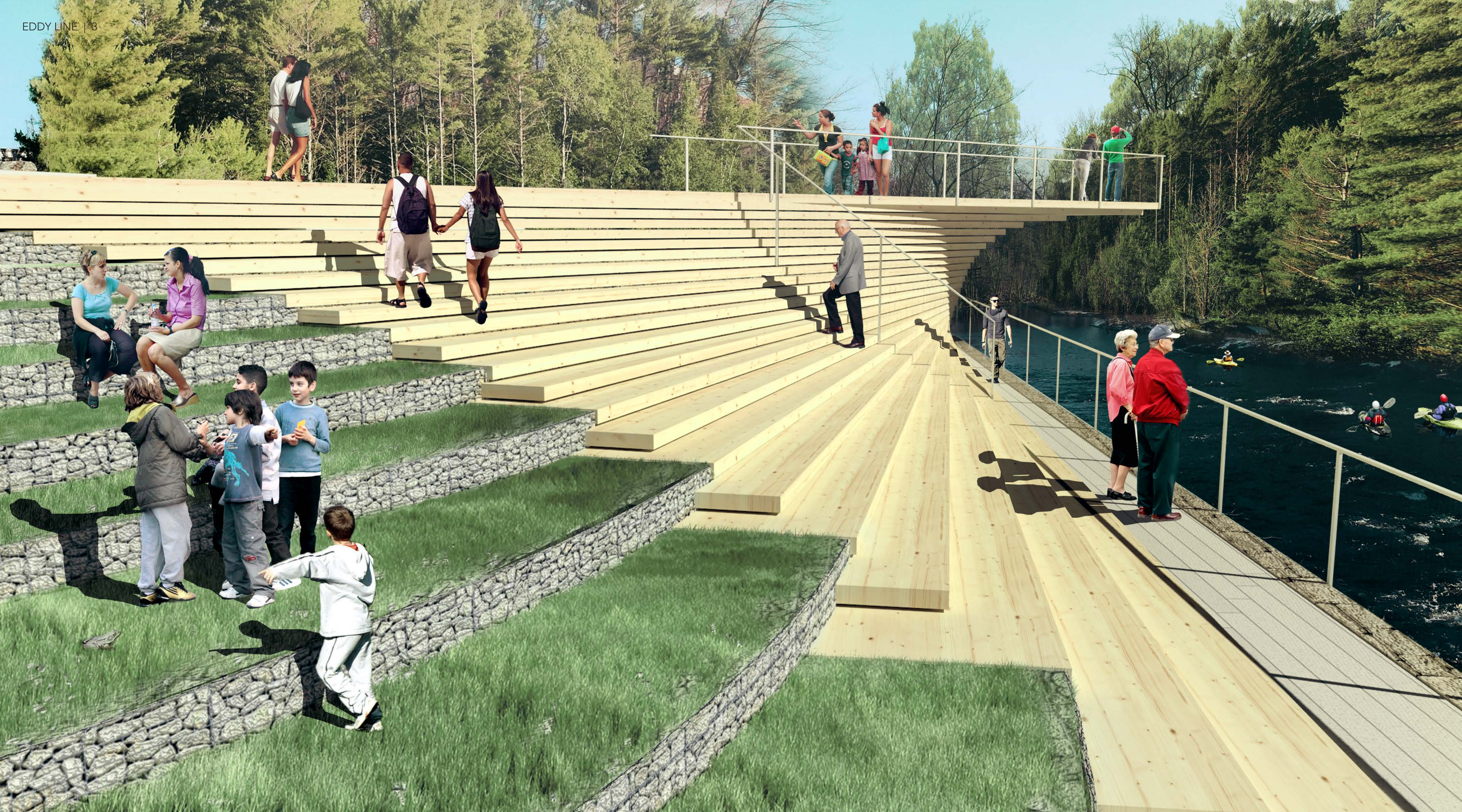

**I. SITE FEATURES**  
Destinations distributed across the site draw visitors across a varied topography.

**II. CONNECTIVE THREADS**  
Three primary axes direct circulation and divide programmatic zones.

**III. FANNING SURFACES**  
Stepped infill surfaces generate seating, overlooks, and the geometry of the solar beacon.





## SITE

The park offers an eddy of calm at the confluence of several natural and man-made flows: water movement along the Willimantic River, vehicular traffic along Bridge street, pedestrian traffic from downtown, as well as bike traffic along the Airline Trail.

